

EN Petrol lawnmower
132 cm³, 41 cm

EN ORIGINAL INSTRUCTIONS

IMPORTANT - These instructions are for your safety. Please read through them thoroughly prior to handling the product and retain them for future reference.



V10925_5063022748980_MAND4_2425_TF001416

NMU1299LWM
5063022748980

EN Parts

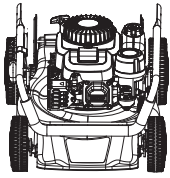

01. x1

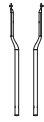

02. x2

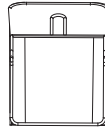

03. x1



04. x1



05. x4
(M8*35 mm, x2)
(M8*43 mm, x2)



06. x1



07. x1



08. x1



09. x1

EN You will need

x2



(items not supplied)

- Suitable personal protective equipment
- Fuel funnel with filter
- Petrol and engine oil
- Fuel collecting container
- Oil collecting container
- Lubrication oil/grease
- Suitable torque wrench
- Suitable spanner

EN Contents

EN	
Product description	3
Safety	4
Preparation	18
Assembly	19
Functions & Settings	24
Use	30
Care & maintenance	34
Guarantee	44
Declaration of conformity	46

EN Product description

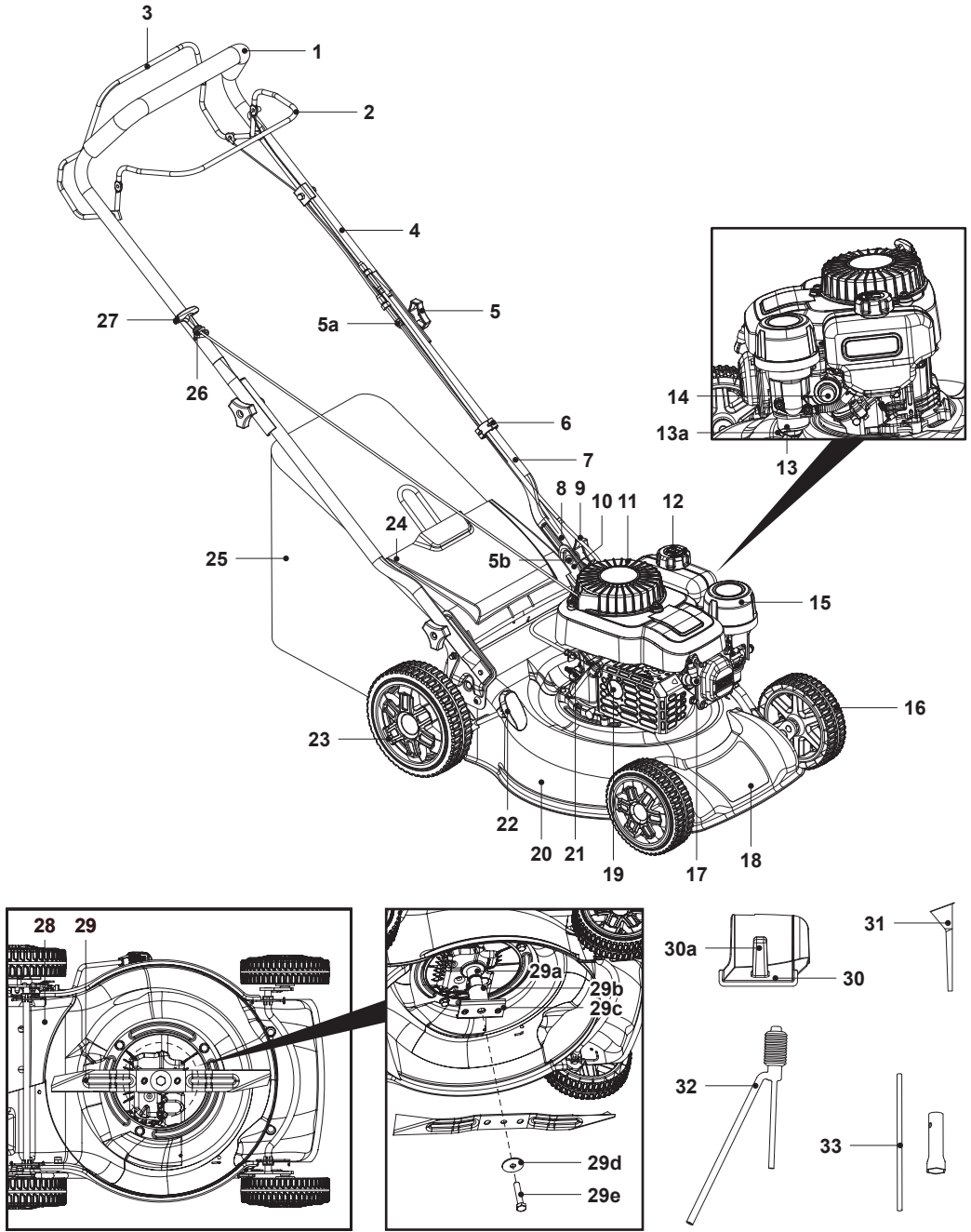

- | | | |
|--------------------------|-------------------------------|------------------------------------|
| 1. Grip handle | 11. Air vents | 25. Grass catcher |
| 2. Brake lever | a. Engine* | a. Carry handle |
| 3. Self-propelling lever | 12. Fuel tank cap | b. Catcher hook* (x2) |
| 4. Upper handle bar | 13. Carburetor | c. Rubber clip* (x5) |
| a. Mounting hole* (x2) | a. Fuel drain screw | d. Supporting rod* |
| 5. Lock knob (x4) | 14. Primer | 26. Hook for recoil starter handle |
| a. Mounting bolt (M8*43) | 15. Air filter cover | 27. Recoil starter handle |
| b. Mounting bolt (M8*35) | a. Air filter* | 28. Rear discharge chute |
| 6. Wire clip | b. Locking latch* (x3) | a. Slot* (x2) |
| 7. Lower handle bar (x2) | 16. Front wheel (x2) | 29. Cutting device (blade) |
| a. Spigot* | 17. Spark plug connector | a. Spindle |
| b. Mounting hole* | a. Spark plug* | b. Bushing |
| 8. Self-propelling wire | 18. Front transport handle | c. Blade holder |
| a. Upper locking sleeve* | 19. Muffler | d. Washer |
| b. Lower locking nut* | 20. Cutting blade compartment | e. Hex bolt |
| 9. Brake wire | 21. Oil tank cap | 30. Mulching insert |
| a. Upper locking sleeve* | 22. Lever for cutting height | a. Handle |
| b. Lower locking nut* | adjustment | b. Locking latch* (x2) |
| 10. Handle bracket (x2) | 23. Rear wheel (x2) | 31. Oil funnel |
| a. Holding hole* | 24. Rear deflector guard | 32. Syphon |
| b. Mounting hole* | | 33. Spark plug wrench |



NOTE: Parts marked with * are not shown in this overview. Please refer to the respective part in the instruction manual.



EN Safety

Petrol powered lawnmowers safety warnings



IMPORTANT

**READ CAREFULLY BEFORE USE.
KEEP FOR FUTURE REFERENCE.**



WARNING! YOUR SAFETY AND THE SAFETY OF OTHERS IS VERY IMPORTANT. OF COURSE, IT IS NOT PRACTICAL OR POSSIBLE TO WARN YOU ABOUT ALL THE HAZARDS ASSOCIATED WITH OPERATING OR MAINTAINING THIS MACHINE. AT ALL TIMES YOU MUST USE YOUR OWN GOOD JUDGMENT.

Training

- Read the instructions carefully. Be familiar with the controls and the proper use of the machine.
- Never allow children or people unfamiliar with these instructions to use the machine. Local regulations can restrict the age of the operator.
- Never mow while people, especially children, or pets are nearby.
- Keep in mind that the operator or user is responsible for accidents or hazards occurring to other people or their property.
- The operators must receive proper training in the use, adjustment and operation of the machine, including prohibited operations.

Preparation

- **Do not use the lawnmower in bad weather conditions, especially when there is a risk of lightning.** This decreases the risk of being struck by lightning.
- **Thoroughly inspect the area for wildlife where the lawnmower is to be used.** Wildlife may be injured by the lawnmower during operation.
- **Thoroughly inspect the area where the lawnmower is to be used and remove all stones, sticks, wires, bones, and other foreign objects.** Thrown objects can cause personal injury.
- **Before using, always visually inspect to see that the cutting devices, cutting device bolts and cutter assembly are not worn or damaged.** Replace worn or damaged cutting devices and bolts in sets to preserve balance.
- **Check the grass catcher frequently for wear or deterioration.** A worn or damaged grass catcher may increase the risk of personal injury.
- **Keep guards in place. Guards must be in working order and be properly mounted.** A guard that is loose, damaged, or is not functioning correctly may result in personal injury.
- **Keep all cooling air inlets clear of debris.** Blocked air inlets and debris may result in overheating or risk of fire.

- **While operating the lawnmower, always wear non-slip and protective footwear. Do not operate the lawnmower when barefoot or wearing open sandals.** This reduces the chance of injury to the feet from contact with the moving blade.
- **While operating the lawnmower, always wear long trousers.** Exposed skin increases the likelihood of injury from thrown objects.



WARNING! PETROL IS HIGHLY FLAMMABLE.

- STORE FUEL IN CONTAINERS SPECIFICALLY DESIGNED FOR THIS PURPOSE.
 - REFUEL OUTDOORS ONLY AND DO NOT SMOKE WHILE REFUELLING.
 - ADD FUEL BEFORE STARTING THE ENGINE. NEVER REMOVE THE FUEL TANK CAP OR ADD PETROL WHILE THE ENGINE IS RUNNING OR WHEN THE ENGINE IS HOT.
 - IF PETROL IS SPILT, DO NOT ATTEMPT TO START THE ENGINE BUT MOVE THE MACHINE AWAY FROM THE AREA OF SPILLAGE AND AVOID CREATING ANY SOURCE OF IGNITION UNTIL PETROL VAPOURS HAVE DISSIPATED.
 - REPLACE ALL FUEL TANK AND CONTAINER CAPS SECURELY.
- Replace faulty silencers.



CAUTION! DO NOT TOUCH ROTATING CUTTING DEVICE.

- Engine brake (brake lever (2)): Use the brake lever (2) to stop the engine. When you release the brake lever (2), the engine and the blade stop automatically in a few second. To mow, hold the brake lever (2) in the working position. Before you start to mow, check the brake lever (2) several times to be sure that it is working properly. Ensure that the brake wire (9) can be smoothly operated (i.e. is not catching or kinking in any way).

Operation

- **Do not operate the lawnmower in wet grass. Walk, never run.** This reduces the risk of slipping and falling which may result in personal injury.
- **Do not operate the lawnmower on excessively steep slopes.** This reduces the risk of loss of control, slipping and falling which may result in personal injury.
- **When working on slopes, always be sure of your footing, always work across the face of slopes, never up or down and exercise extreme caution when changing direction.** This reduces the risk of loss of control, slipping and falling which may result in personal injury.
- **Use extreme caution when reversing or pulling the lawnmower towards you. Always be aware of your surroundings.** This reduces the risk of tripping during operation.
- **Do not touch blades and other hazardous moving parts while they are still in motion.** This reduces the risk of injury from moving parts.
- **When clearing jammed material or cleaning the lawnmower, stop the engine and wait that the cutting blade had come to a complete stop.** Unexpected operation of the lawnmower may result in serious personal injury.
- Do not operate the engine in a confined space where dangerous carbon monoxide fumes can collect.
- Mow only in daylight or in good artificial light.
- Do not operate the lawnmower in rain or wet conditions.
- Do not operate the machine while being tired, ill or under influence of alcohol or drugs.

- Do not mow excessively steep slopes near drop-offs, ditches or embankments.
- Stop the cutting device(s) if the machine has to be tilted for transportation when crossing surfaces other than grass, and when transporting the machine to and from the area to be mowed.
- Never operate the machine with defective guards, shields, or without safety devices, for example deflectors, self-closing discharge opening guard and/or grass catchers, in place.
- Do not change the engine governor settings or overspeed the engine.
- Do not alter or tamper with any sealed adjustments for the engine speed control.
- Do not tamper or disable any machine's safety systems or features.
- Ensure and regularly check that all starting interlocks and operator presence controls are properly functioning.
- Stop the machine according to instructions in this manual before leaving the operator's position and park it in a safe location.
- Start the engine or switch on the engine carefully according to instructions and with feet well away from the cutting device(s).
- Do not tilt the machine when starting the engine or switching on the engine, except if the machine has to be tilted for starting. In this case, do not tilt it more than absolutely necessary and lift only the part which is away from the operator. Always ensure that both hands are in the operating position before returning the appliance to the ground.
- Keep hands and feet away from the cutting means at all times and especially when switching on the engine.
- Do not put hands or feet near or under rotating parts. Keep clear of the discharge opening at all times.
- Never pick up or carry a machine while the engine is running.
- In case of any situation mentioned below, stop the engine and disconnect the spark plug connector, make sure that all moving parts have come to a complete stop and, where a key is fitted remove the key:

- before clearing blockages or unclogging chute,
 - before checking, cleaning or working on the machine,
 - after striking a foreign object. Inspect the machine for damage and make repairs before restarting and operating the machine,
 - if the machine starts to vibrate abnormally (check immediately).
 - > inspect for damage
 - > replace or repair any damaged parts
 - > check for and tighten any loose parts
 - whenever you leave the machine,
 - before refuelling.
- Never touch the exhaust, exhaust guard or cooling fins when the engine is hot.
 - Never carelessly touch hot parts of the machine, you can burn yourself. While the machine is in operation or shortly thereafter, its parts such as the exhaust pipe, engine, and other surfaces are extremely hot! Pay attention to the markings on the machine.
 - Make sure that the air vents of the combustion engine are clear. Keep the air vents free of dust, dirt particles, gases and fumes.
 - Never start or run the engine indoors. The exhaust fumes are dangerous, containing carbon monoxide, an odourless and deadly gas. Operate this machine only in well ventilated outdoor areas.

Maintenance and storage

- Follow the maintenance and repair instructions for this machine. Never carry out any modifications of the machine. Never change the preset rotary speed or the engine and machine settings. Information about maintenance and repair is provided in this user manual.
- Keep all nuts, bolts and screws tight to be sure the machine is in safe working condition.
- Improper maintenance, using non-genuine parts, or removing / modifying safety components may lead to malfunction / failure of the machine and injury of operators. Many accidents are caused by poorly maintained machines.
- Never store the machine with petrol in the tank inside a building where fumes can reach an open flame or spark.

- To reduce the fire hazard, keep the engine, silencer and petrol storage area free of grass, leaves, or excessive grease to reduce the fire hazard.
- Allow the engine to cool before storing in any enclosure. Clean and maintain the machine before storage.
- Check the grass catcher frequently for wear or deterioration.
- If the fuel tank has to be drained, this should be done outdoors.
- Wear strong work gloves when removing and re-assembling the cutting device.
- Replace worn or damaged parts for safety. Use only the genuine replacement parts and spare parts.
- Ensure that only replace the recommended cutting means (blade) with the right type.

Fuel handling

- Before refuelling, stop the engine, disconnect the spark plug connector and let the machine cool. Fuel and fuel vapours are highly flammable. Take care when handling fuel. Never smoke when you are refuelling the machine. Do not refuel the machine, if there is an open fire in the vicinity!
- Always use suitable aids such as funnels and filler necks. Do not spill any fuel on the machine or its exhaust system. There is a risk of ignition. However, if fuel should be spilled, then you must remove it carefully from all parts of the machine. Any residue which may be present must be completely removed, before the machine is operated!
- Never refuel indoors. Exhaust gases and fuel fumes are noxious.
- Never use the machine in environments where there is a risk of explosion. Fuel fumes can ignite.
- Never breathe in any fuel fumes, when you are refuelling the machine. Never fill the tank in enclosed spaces, such as basements or sheds. There is a risk of poisoning and explosion!
- Avoid skin contact with petrol.
- Do not eat or drink, while you are refuelling the machine. If you have swallowed petrol or oil, or if petrol or oil has got into your eyes, then seek medical advice immediately.

- Close the fuel tank cap immediately after filling the fuel tank. Make sure that it is properly closed.
- Never use the machine without an air filter.
- Fuel vapour pressure may build up inside the fuel tank depending on the fuel used, weather conditions and the tank venting system. To reduce the risk of burns and other personal injuries, remove the fuel cap carefully to allow any pressure build up to release slowly.
- Be aware of fire risks, explosion and inhalation risks.
- Do not smoke while operating the machine, handling fuel or near fuel.
- Ensure the spark plug lead is secured; a loose lead may cause electrical arcing that could ignite combustible fumes and cause a fire or explosion.
- Check regularly for leaks from the fuel cap and fuel lines.
- Do use caution when handling fuel. To avoid any accidental fires, move the machine at least 3 metres (10') from the fuelling point before starting the engine.
- Tighten the fuel tank cap thoroughly after refilling the fuel tank.
- Do not operate the machine if it is leaking fuel. Do not remove the fuel tank cap while the engine is running.
- Use only an approved container for this purpose.
- Do not store cans of fuel or refill the fuel tank in any place where there is a boiler, stove, wood fire, electrical sparks, welding sparks, or other sources of heat or fire which might ignite the fuel.
- If any fuel spillage occurs during refuelling, use a dry rag to wipe up spills and allow remaining fuel to evaporate before turning the engine on again.
- If you have spilt fuel on yourself or on your clothes, change your clothes and wash any part of your body that has come in contact with fuel before turning the engine on again.
- If fuel is ignited, put out the fire with a dry powder fire extinguisher.
- If the fuel tank is drained, this should be done outdoors.

Vibration and noise reduction

To reduce the impact of noise and vibration emission, limit the time of operation, use low-vibration and low-noise operating modes as well as wear personal protective equipment.

Take the following points into account to minimize the vibration and noise exposure risks:

- Only use the machine as intended by its design and these instructions.
- Ensure that the machine is in good condition and well maintained.
- Use correct attachments for the machine and ensure they are in good condition.
- Keep tight grip on the handles/gripping surface.
- Maintain this machine in accordance with these instructions and keep it well lubricated (where appropriate).
- Plan your work schedule to spread any high vibration tool use across a longer period of time.
- Prolonged use of the product exposes the user to vibrations that can cause a range of conditions collectively known as hand-arm vibration syndrome (HAVS) e.g. fingers going white; as well as specific diseases such as carpal tunnel syndrome. To reduce this risk when using the product, always wear protective gloves and keep your hands warm.

Emergency

Familiarise yourself with the use of this machine by means of this instruction manual. Memorise the safety directions and follow them to the letter. This will help to prevent risks and hazards.

- **Always be alert when using this machine, so that you can recognize and handle risks early.** Fast intervention can prevent serious injury and damage to property.
- **Stop the engine and disconnect the spark plug connector if there are malfunctions.** Have the machine checked by a qualified professional and repaired, if necessary, before you operate it again.

- **In case of fire stop the engine and disconnect the spark plug connector.** Take fire-extinguishing measures immediately if the machine switch is no longer accessible.



WARNING! NEVER USE WATER TO EXTINGUISH A MACHINE ON FIRE. BURNING FUEL MUST BE EXTINGUISHED WITH SPECIAL EXTINGUISHING AGENTS! WE RECOMMEND THAT YOU KEEP A SUITABLE FIRE EXTINGUISHER WITHIN REACH IN YOUR WORK AREA!

Residual risks

Even if you are operating this machine in accordance with all the safety requirements, potential risks of injury and damage remain. The following dangers can arise in connection with the structure and design of this machine:

- Health defects resulting from vibration emission if the machine is being used over long periods of time or not adequately managed and properly maintained.
- Injuries and damage to property due to broken application tools or the sudden impact of hidden objects during use.
- Danger of injury and property damage caused by flying objects.
- Burns, if touching hot surfaces.



WARNING! THIS MACHINE PRODUCES AN ELECTROMAGNETIC FIELD DURING OPERATION! THIS FIELD MAY UNDER SOME CIRCUMSTANCES INTERFERE WITH ACTIVE OR PASSIVE MEDICAL IMPLANTS! TO REDUCE THE RISK OF SERIOUS OR FATAL INJURY, WE RECOMMEND PERSONS WITH MEDICAL IMPLANTS TO CONSULT THEIR DOCTOR AND THE MEDICAL IMPLANT MANUFACTURER BEFORE OPERATING THIS MACHINE!

Symbols

On the machine, the rating label and within these instructions you will find among others the following symbols and abbreviations. Familiarise yourself with them to reduce hazards like personal injuries and damage to property.

kW	Kilowatt	cm ³	Cubic centimetre
L/h	Litre per hour	g/kWh	Gram per kilowatt per hour
/min or min ⁻¹	Per minute	°C	Degree Celsius
mm	Millimetre	cm	Centimetre
g	Gram	kg	Kilogram
dB(A)	Decibel (A-rated)	m/s ²	Metres per seconds squared
ml	Millilitre	L	Litre



Lock / to tighten or secure.



Unlock / to loosen.



Read the instruction manual.



Note / Remark.



CAUTION! / WARNING! / DANGER!

yyWxx Manufacturing date code; year of manufacturing (20yy) and week of manufacturing (Wxx).



Wear hearing protection.
Wear eye protection.



Wear respiratory protection.



Wear protective gloves.



Wear protective, slip-resistant footwear.



Wear tight-fitted protective clothes.



Do not expose the machine to rain or wet conditions (moisture).



Open flames in the work area, around the machine and in the vicinity of flammable materials are prohibited!



Do not smoke in the work area, around the machine and in the vicinity of flammable materials!



Risk of fire / flammable materials.



Hot surface, do not touch!



High temperatures on the machine's surfaces and structural parts that could cause burns, if they are touched. The machine can also stay hot for a longer period of time after operation!



This machine produces noxious exhaust fumes. If the machine is used improperly, these fumes can lead to poisoning, a loss of consciousness or death!



Noxious exhaust fumes; do not operate or start the machine in indoor rooms!



CAUTION / WARNING!

Only refuel unleaded petrol!



Add engine oil.



Check and refill oil.



Stop the engine off while you are refilling the tanks!

Fuel is flammable, keep fire away. Do not add fuel with running engine.



Mow across the face of slopes, never up and down.



Inspect the area where the machine is to be used and remove all objects which can be thrown by the machine.

If objects are hidden while operating, stop the engine and remove the object.



Keep hands and feet away.



Keep hands and feet away from sharp rotating parts - danger of injury!

When cleaning, repairing, or inspecting, make certain the cutting device and all mowing parts have stopped. Disconnect the spark plug connector, and keep the connector away from the plug to prevent accidental starting.



Stop the engine and disconnect the spark plug connector before assembly, cleaning, adjustments, maintenance, storage and transportation.



Cutting device continues to rotate after the machine is switched off.

Wait until all machine components have completely stopped before touching the machine.



Pay special attention when working on the cutting device (blade)!



Objects thrown by the machine could hit the user or other bystanders.

Always ensure that other people and pets remain at a safe distance from the machine when it is in operation. In general, children must not come near the area where the machine is.

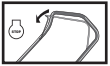

Release the brake lever (2) to stop the engine and blade.



Push the self-propelling lever (3) forward to engage the wheels.



Engine manual start; recoil starter.



Press the primer (14) three times.



Guaranteed sound power level value in 96 dB.



The machine complies with the applicable European directives and an evaluation method of conformity for these directives was done.

Technical specifications

General

- > **Dimensions** : 1355 x 490 x 1135 mm
- > **Machine mass with empty tanks and in normal operating configuration** : approx. 22.25 kg
- > **Fuel tank capacity** : 750 ml (cm³)
- > **Petrol type** : Octane rating of at least 90, unleaded, maximum 10% renewable ethanol. E5 fuel is strongly recommended for enhanced performance and longevity.
- > **Engine oil capacity** : 400 ml (cm³)
- > **Engine oil type** : Synthetic or semi-synthetic 4-stroke engine oil
- > **Specific fuel consumption at max. engine power** : 382 g/kWh
- > **Fuel consumption at max. engine power** : 0.92 L/h

- > **Cutting device** : SMV 1255261000, Thickness 2.5 mm
- > **Cutting width** : 41 cm
- > **Cutting height** : 25-75 mm, 7 levels
- > **Grass catcher volume** : 45 L

Engine

- > **Engine model** : NP130
- > **Engine type** : air cooled, 4-stroke engine
- > **Engine displacement** : 132 cm³
- > **Rated engine speed** : 2900 min⁻¹
- > **Maximum operating engine speed (rotational frequency)** : 2900 min⁻¹
- > **Nominal power** : 2.1 kW (2900 min⁻¹)
- > **Spark plug type** : F6RTC
- > **Spark plug gap** : 0.7-0.8 mm
- > **Carburetor** : KEIMA NP130 / 1TJSQC13J

Sound level

- > **Sound pressure level at operator's position L_{pA}** : 81.2 dB(A)
- > **Uncertainty K_{pA}** : 3 dB(A)
- > **Sound power level L_{WA}** : 94.24 dB(A)
- > **Uncertainty K_{WA}** : 1.12 dB(A)
- > **Guaranteed sound power level L_{WA} (acc. to 2000/14/EC amended by 2005/88/EC)** : 96 dB(A)

Vibration level

- > **Hand arm vibration a_{hw}** : Left / Right 5.29 / 5.51 m/s²
- > **Uncertainty K** : 1.5 m/s²

The sound values have been determined according to noise test code given in EN ISO 5395-1 and EN ISO 5395-2, using the basic standards ISO 3744 and ISO 11094.

Wear hearing protection, especially when sound pressure is over 80 dB(A).

The declared vibration value has been measured in accordance with a standard test method (according to EN ISO 5395-1 and EN ISO 5395-2) and may be used for comparing one machine with another. The declared vibration value may also be used to evaluate the exposure for the user caused by vibration in advance.



WARNING! DEPENDING ON THE ACTUAL USE OF THE MACHINE THE VIBRATION VALUES CAN DIFFER FROM THE DECLARED TOTAL! ADOPT PROPER MEASURES TO PROTECT YOURSELF AGAINST VIBRATION EXPOSURES. TAKE THE WHOLE WORK PROCESS INCLUDING TIMES THE MACHINE IS RUNNING UNDER NO LOAD OR SWITCHED OFF INTO CONSIDERATION.

PROPER MEASURES INCLUDE AMONG OTHERS REGULAR MAINTENANCE AND CARE OF THE MACHINE AND APPLICATION TOOLS, KEEPING HANDS WARM, PERIODICAL BREAKS AND PROPER PLANNING OF WORK PROCESSES.

Rating label explanation

Petrol Lawn Mower: NMU1299LWM = Model number

NM = No name (brand name)

U = Petrol power

1299 = Sequential number

LWM = Lawn mower

EN Preparation

Unpacking



NOTE: The machine is heavy, ask another person for assistance if required.

1. Unpack all parts and lay them on a flat, stable surface.
2. Remove all packing materials and shipping devices if applicable.
3. Make sure the delivery contents are complete and free of any damage. If you find that parts are missing or show damage do not use the machine but contact your dealer. Using an incomplete or damaged machine represents a hazard to people and property.
4. Ensure that you have all the accessories and tools needed for assembly and operation. This also includes suitable personal protective equipment.



WARNING! THE MACHINE AND THE PACKAGING ARE NOT CHILDREN'S TOYS! CHILDREN MUST NOT PLAY WITH PLASTIC BAGS, SHEETS AND SMALL PARTS! THERE IS A DANGER OF CHOKING AND SUFFOCATION!

You will need

(items not supplied)

Suitable personal protective equipment
Fuel funnel with filter
Petrol and engine oil
Fuel collecting container
Oil collecting container
Lubrication oil/grease
Suitable torque wrench
Suitable spanner

(items supplied)

Grass catcher (25)
Cutting device (blade) (29)
Mulching insert (30)
Oil funnel (31)
Syphon (32)
Spark plug wrench (33)



NOTE: The accessories required depend on the intended application. Ask your dealer for advice.

EN Assembly



WARNING! THE MACHINE MUST BE FULLY ASSEMBLED BEFORE OPERATION! DO NOT USE A MACHINE THAT IS ONLY PARTLY ASSEMBLED OR ASSEMBLED WITH DAMAGED PARTS!



WEAR PROTECTIVE GLOVES FOR THIS ASSEMBLY WORK AND ALWAYS LAY THE MACHINE ON A FLAT AND STABLE SURFACE WHILE ASSEMBLING.



FOLLOW THE ASSEMBLY INSTRUCTIONS STEP-BY-STEP AND USE THE PICTURES PROVIDED AS A VISUAL GUIDE TO EASILY ASSEMBLE THE MACHINE!

BEFORE USING THE MACHINE, FAMILIARISE YOURSELF WITH THE OPERATING FEATURES READ THE ENTIRE INSTRUCTION MANUAL PAYING PARTICULAR ATTENTION TO THE SAFETY RULES AND OPERATING PROCEDURES.

DISCONNECT THE SPARK PLUG CONNECTOR (17) FROM THE SPARK PLUG! RECONNECT IT AFTER ASSEMBLY.



NOTE: Take care of small parts that are removed during assembly or when making adjustments. Keep them secure to avoid loss.



NOTE: There are two sizes of mounting bolts, M8*35 and M8*43. We recommend using the mounting bolts (M8*35) (5b) to assemble the two lower handle bars (7) and using the mounting bolts (M8*43) (5a) to assemble the upper handle bar (4).

Lower handle bar

1. Put the machine on the ground.
2. Unscrew the two lock knobs (5) anti-clockwise from the thread of the mounting bolts (M8*35) (5b) for use. Keep them handy to avoid loss.
3. Keep one lower handle bar (7) protrudes outward, then align and engage its spigot (7a) in the holding hole (10a) of the handle bracket (10). Keep the handle assembly in position.
4. Align and pass one mounting bolt (M8*35) (5b) through the mounting holes (10b, 7b) of the handle bracket (10) and the lower handle bar (7) until the stop, then attach the lock knob (5) (Fig. 1, step 1).
5. Secure the handle assembly by screwing in the lock knob (5) clockwise on the thread of the mounting bolt (M8*35) (5b) (Fig. 1, step 2).
6. Repeat the above steps on the other lower handle bar (7).
7. Make sure that the self-propelling wire (8) and the brake wire (9) run on the upper side of the lower handle bar (7).

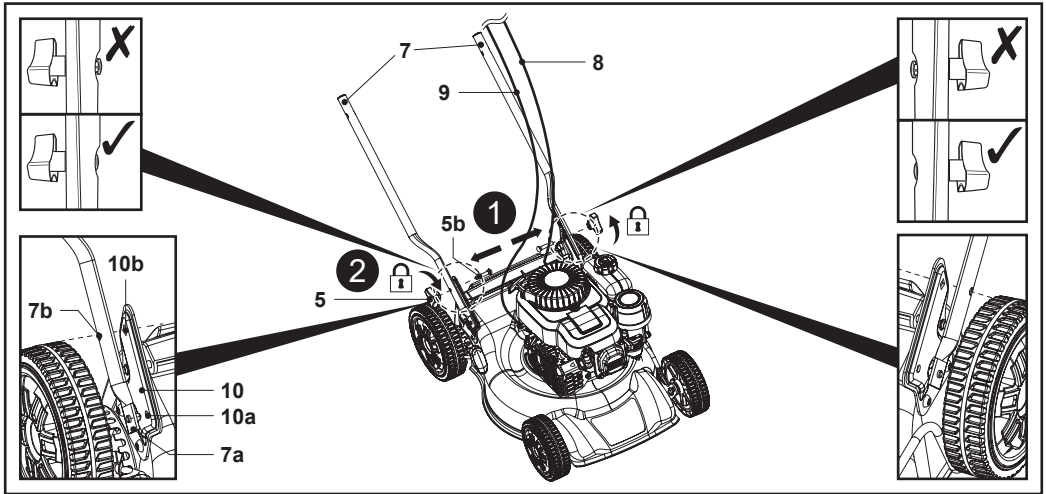

Fig. 1

Upper handle bar

1. Align the mounting holes of the upper handle bar (4) and the two lower handle bars (7). Ensure that the upper handle bar (4) with the brake lever (2) facing upwards.
2. Pass one mounting bolt (M8*43) (5a) through the mounting holes (7b, 4a) of the lower handle bar (7) and the upper handle bar (4) until the stop (Fig. 2, step 1), then attach the lock knob (5).
3. Secure the handle assembly by screwing in the lock knob (5) clockwise on the thread of the mounting bolt (M8*43) (5a) (Fig. 2, step 2).

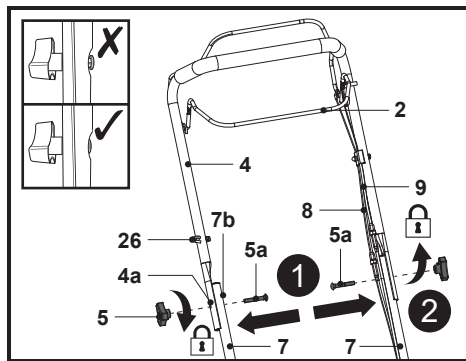

Fig. 2

4. Repeat the above steps on the other side of upper handle bar (4).
5. Make sure that the pre-assembled hook for recoil starter handle (26) rest on your right-hand side (when viewed from operator's position).
6. Make sure that the self-propelling wire (8) and the brake wire (9) run on the upper side of the handle bars (4, 7).
7. Attach the wires (8, 9) with the wire clip (6) on the left-hand side of the lower handle bar (7) (when viewed from operator's position) (Fig. 3).

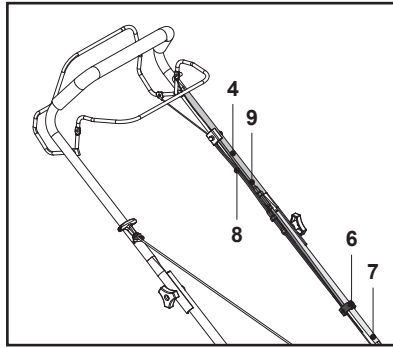

Fig. 3

Grass catcher

1. Clip the rubber clips (25c) onto the supporting rod (25d) of the grass catcher (25) (Fig. 4) if not pre-assembled at delivery status.
2. The grass catcher (25) is now ready for use.

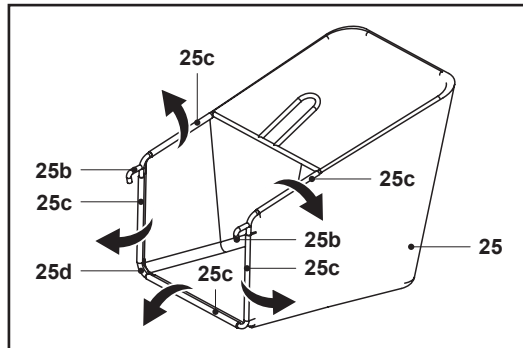

Fig. 4

3. Open the rear deflector guard (24) and hold it in position (Fig. 5, step 1).
4. Carry the grass catcher (25) by its carry handle (25a).
5. Align the two grass catcher hooks (25b) with the rods and hang the grass catcher (25) onto it (Fig. 5, step 2).
6. Carefully release the rear deflector guard (24) afterward.

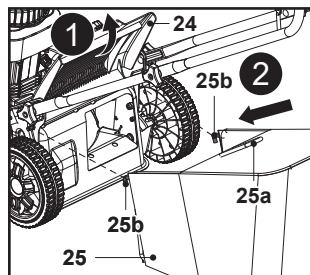

Fig. 5



NOTE: Always carry the grass catcher (25) by its carry handle (25a). Before hooking the grass catcher (25), check if the mulching insert (30) is in the rear discharge chute (28). Take away the mulching insert (30) before hooking the grass catcher (25).



NOTE: The mulching insert (30) must be removed if the grass catcher (25) is used.

Fuel and engine oil

This machine is equipped with a 4-stroke engine. Before operation it is necessary to add proper fuel and engine oil separately.

1. Place the machine on a stable, level surface. We recommend laying a non-flammable sheet under the machine.
2. Use proper funnels. Avoid spilling and overfilling the tanks.



WARNING! FUEL AND OIL ARE HIGHLY INFLAMMABLE! FUMES WILL EXPLODE IF LIT! ENSURE THAT THERE ARE NO NAKED FLAMES AROUND THE MACHINE! DO NOT SMOKE WHILE FILLING FUEL AND OIL!



3. Always dispose of fuel, used oil and objects contaminated with them in accordance with local regulations.

Fuel



NOTE: This machine is not supplied with fuel! Before operating this machine, it is essential to fill it with fuel! Fill fuel and engine oil separately. Never mix oil with petrol!



1. Always use clean, fresh unleaded petrol. Purchase fuel in quantities that can be used within 30 days.
2. Never mix oil with petrol. Avoid getting dirt, dust or water in the fuel tank.
3. Unscrew and remove the fuel tank cap (12) (Fig. 6).
4. Add suitable fuel into the fuel tank. Leave a minimum 5 mm of space between the top of the fuel and the inside edge of the tank to allow for expansion (Fig. 7).

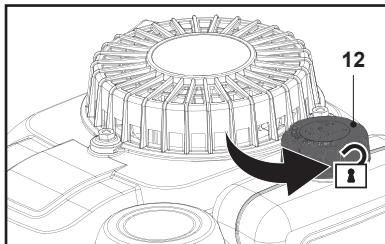

Fig. 6

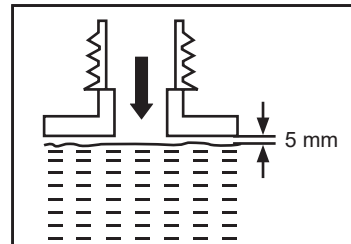

Fig. 7



WARNING! STALE FUEL WILL REDUCE PERFORMANCE AND MAY DAMAGE YOUR MACHINE. FUEL STABILISER/ENHANCERS MUST BE USED WITH FUEL TO PROLONG THE FUEL LIFE AND PROTECT THE MACHINE.

BEFORE STORING THE MACHINE, DRAIN THE FUEL INTO A PROPER CONTAINER AND THEN RUN THE ENGINE UNTIL IT STOPS FROM LACK OF FUEL.



NOTE: Towards the end of the season, it is advisable to put only as much fuel in the tank as you need for each use, since it should be completely used up before storing the machine.

5. Wipe any spilled fuel with a soft cloth and reattach the fuel tank cap (12).

Engine oil



WARNING! THIS MACHINE IS NOT SUPPLIED WITH OIL. HOWEVER, FOR MANUFACTURING REASONS IT IS POSSIBLE THAT A SMALL QUANTITY MAY BE IN THE ENGINE! BEFORE OPERATING THIS MACHINE, IT IS ESSENTIAL TO FILL IT WITH PROPER OIL (4-STROKE ENGINE OIL, E.G. SAE 10W-30)!

ENGINE OIL HAS A MAJOR INFLUENCE ON ENGINE PERFORMANCE AND SERVICE LIFE. NON- DETERGENT OR 2-CYCLE ENGINE OILS WILL DAMAGE THE ENGINE AND SHOULD NOT BE USED!

1. Unscrew and remove the oil tank cap (21) (Fig. 8, step 1).
2. Gradually add good-quality engine oil (SAE 10W-30) with the supplied oil funnel (31) (Fig. 8, step 2). Allow the oil to settle.
3. Check the oil level frequently while filling. Wipe off oil dipstick and insert it into the tank opening without tightening the oil tank cap (21), and then remove the dipstick again.

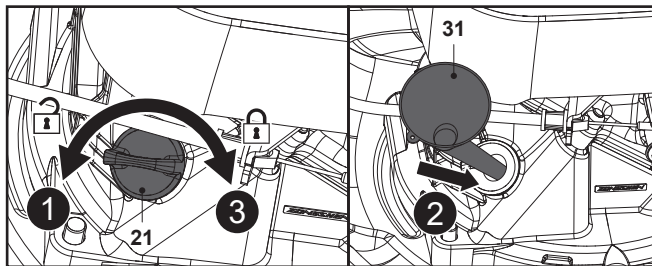

Fig. 8

4. The oil level must be between the “max” and “min” of the oil level markings. Add more oil if necessary. Do not overfill (Fig. 9).
5. After adding oil, wait a minute and then recheck the oil level.
6. Wipe spilled oil with a soft cloth and reattach the oil tank cap (Fig. 8, step 3).

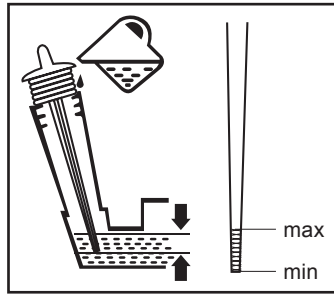
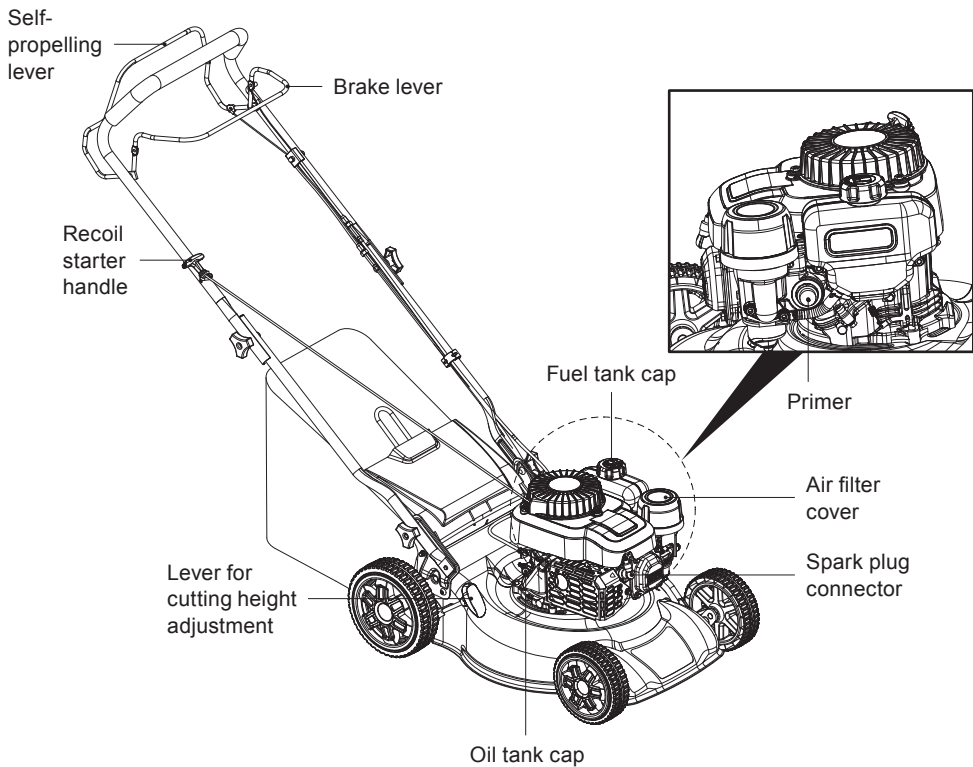

Fig. 9

EN Functions & Settings

Operating controls



Set up



Assemble



Adjust



Add fuel



Add oil

Start



Press the primer (14)
3 times for cold engine
start



Pull back the brake
lever (2) & hold it in
position



Pull recoil starter
handle (27), repeat until
engine starts



Push the self-propelling
lever (3) & hold it in
position



Operate

Stopping



Release the brake
lever (2)

Storage



Empty fuel tank



Empty oil tank



Clean and maintain



Store



WARNING! THIS QUICK START PROVIDES ONLY A SHORT OVERVIEW OF HOW TO START AND STOP THE MACHINE! FOR SAFE USE IT IS ESSENTIAL TO READ THE ENTIRE INSTRUCTION MANUAL BEFORE FIRST USE!

Intended use

This petrol lawn mower NMU1299LWM is designated with a power output of 2.1 kW.

The machine is intended for mowing grass in domestic gardens only. It must not be used to mow unusually high, dry or wet grass, e.g. pasture grass, or to shred leaves.

For safety reasons it is essential to read the entire instruction manual before first operation and to observe all the instructions therein.

This machine is intended for private domestic use only, not for any commercial trade use. It must not be used for any purposes other than those described.

Brake lever

1. Pull back the brake lever (2) and hold it against the grip handle (1) when starting the engine. Keep it squeezed during operation (Fig. 10).
2. Release the brake lever (2) to stop the engine.

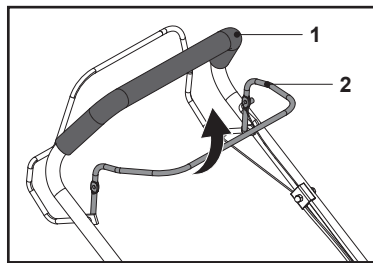

Fig. 10

Recoil starter

The recoil starter handle (27) is positioned at the top of the engine.

1. Pull back the brake lever (2) and hold it against the grip handle (1) (Fig. 10).
2. Pull the recoil starter handle (27) lightly until you feel resistance then pull it rapidly. Do it repeatedly until the engine starts (Fig. 11).
3. Always rest the recoil starter handle (27) onto the hook (26) located on the right-hand side of the upper handle bar (4) (Fig. 12) when the recoil starter is not operated.

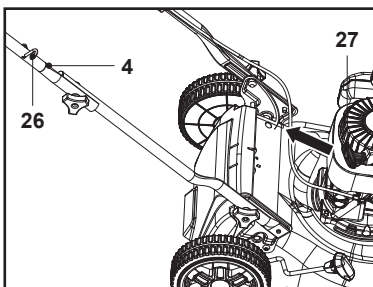

Fig. 11

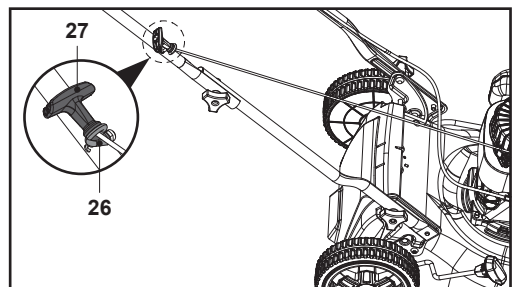

Fig. 12



WARNING! NEVER TWIST THE STARTER CORD AROUND YOUR HAND! ONLY PULL ON THE RECOIL STARTER HANDLE (27)!

DO NOT SUDDENLY RELEASE THE RECOIL STARTER HANDLE (27)! ALLOW THE STARTER CORD TO RETURN SLOWLY AND IN A CONTROLLED MANNER EACH TIME IT IS PULLED!

Self-propelling lever

Use the self-propelled function as assistance during operation; the rear wheels are automatically driven by the engine; you do not need to push the machine manually.

1. Push the self-propelling lever (3) forward and hold it against the grip handle (1) to engage the rear wheels (23) (Fig. 13).
2. Release the self-propelling lever (3) to disengage the rear wheels (23).

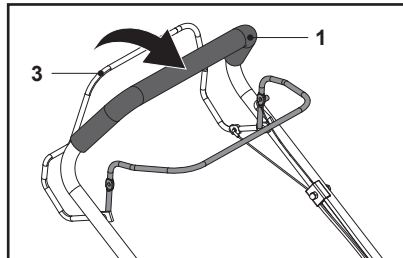

Fig. 13

Grass catcher



WARNING! DO NOT ATTEMPT TO USE THE MACHINE WITHOUT THE GRASS CATCHER ATTACHED WHEN COLLECTING GRASS - DANGER OF FLYING OBJECTS!

WHEN USING THE MACHINE WITHOUT THE GRASS CATCHER (25), INSERT THE MULCHING INSERT (30).

STOP THE ENGINE AND WAIT THAT THE CUTTING BLADE (29) HAD COME TO A COMPLETE STOP BEFORE REMOVING THE GRASS CATCHER (25)!

1. Always attach the grass catcher (25) when using the machine for grass collection as described in the "Assembly - grass catcher" section.
2. Always carry the grass catcher (25) by its carry handle (25a).

Emptying



WARNING: STOP THE ENGINE AND WAIT THAT THE CUTTING BLADE (29) HAD COME TO A COMPLETE STOP BEFORE REMOVING THE GRASS CATCHER (25)!

Empty the grass catcher (25) frequently during use. Do not wait until it is completely full. We recommend emptying it when it is 90% full or when the grass clippings are left to the side or behind the machine.



NOTE: A full grass catcher (25) will reduce the performance of this machine.

1. Open the rear deflector guard (24) and hold it in place, then lift the grass catcher hooks (25b) off the slots and remove the grass catcher (25).
2. Remove the grass clippings from the rear discharge chute (28) into the grass catcher (25). Use a proper tool such as a brush.
3. Remove the grass catcher (25) by its carry handle (25a).
4. Empty the grass clippings onto a compost heap by its carry handle (25a).
5. Re-fit the grass catcher (25) onto the machine and ensure the grass catcher hooks (25b) to stay correctly onto the slots as described in the "Assembly - grass catcher" section.



WARNING! NEVER USE YOUR HANDS OR FEET TO REMOVE GRASS CLIPPINGS FROM THE REAR DISCHARGE CHUTE (28)!



Mulching insert

The mulching insert prevents grass from being collected by blocking the rear discharging chute (28).

This allows the grass clippings to be deposited back on the lawn during cutting.



NOTE: Mulching means cutting and returning the grass clippings to the lawn in one step: the grass clippings are cut very fine and then distributed evenly back onto the lawn. Under normal conditions, the mulched grass will biodegrade quickly to provide nutrients to the lawn.

Do not attach the grass catcher (25) and the mulching insert (30) at the same time.

1. Open the rear deflector guard (24), hold the mulching insert handle (30a) and insert the mulching insert (30) into the rear discharge chute (28) (Fig. 14). Ensure the two locking latches (30b) are properly snapped into the rear discharge chute slots (28a).
2. Pull the mulching insert handle (30a) and release the two locking latches (30b) from the rear discharge chute slots (28a), then remove the mulching insert (30) (Fig. 15).

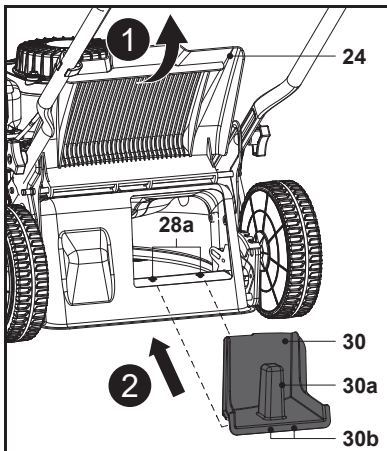

Fig. 14

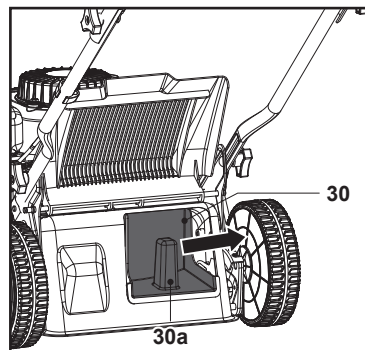

Fig. 15

Cutting height adjustment



WARNING: STOP THE ENGINE AND WAIT THAT THE CUTTING BLADE (29) HAD COME TO A COMPLETE STOP BEFORE ADJUSTING THE CUTTING HEIGHT!

FOR THE FIRST CUT OF THE SEASON, A SUITABLE CUTTING HEIGHT SHOULD BE CHOSEN. DO NOT CHOOSE A LOW CUTTING HEIGHT IF THE GRASS IS LONG AND GREASY, THE ENGINE MAY NOT BE ABLE TO BOOT PROPERLY.

WHEN STARTING THE MOWER DID AN AUDIT OF THE HEIGHT OF THE GRASS. IF THE GRASS IS TOO TALL, THE MOWER WILL NOT START. IT WILL THEN INCREASE THE CUTTING HEIGHT. THIS FEATURE ALLOWS YOU TO IMPROVE THE LIFE OF ENGINE.

Adjust the cutting height according to the needs of your lawn. The cutting height depends on the kind of lawn and its actual height. When mowing high grass, start with the maximum cutting height and make a second cut with a lower cutting height.

1. Pull the lever for cutting height adjustment (22) towards the rear wheel (23) (Fig. 16, step 1) and hold it in position.
2. Move the lever for cutting height adjustment (22) forward or backward to the desired cutting height (Fig. 16, step 2).
3. Release the lever for cutting height adjustment (22) and ensure it engages into place properly (Fig. 16, step 3).

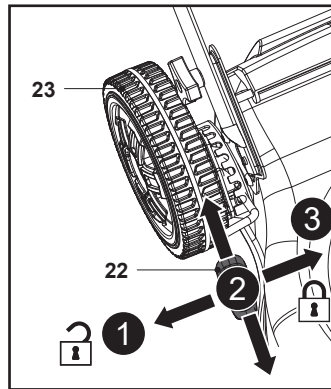

Fig. 16



WARNING! ENSURE THAT THE LEVER FOR CUTTING HEIGHT ADJUSTMENT (22) ENGAGES BETWEEN TWO OF THE PRONGS AFTER EACH ADJUSTMENT.



NOTE: There are 7 cutting height levels available. The adjustable heights are from 25 mm to 75 mm.

General operation

1. Before each use:
 - Check the machine and accessories for damage and whether they are properly fixed. Do not use the machine if it is damaged or shows signs of wear and tear. Take care of any problem you find or have the machine checked by qualified specialist.
 - Check the fuel and oil level. Refill if necessary.
 - Look around and underneath the machine for signs of oil or fuel spill.
 - Check each control for proper operation.
 - Check the cutting blade (29) for wear.
 - Make sure that all bolts and screws are tightened.
 - Check if the air filter (15a) is clean.
2. Always push the machine using the grip handle (1). Use the self-propelling function if required. Keep the handle bar dry and free from lubricant to ensure safe support.
3. Ensure that the air vents (11) are always unobstructed and clear. Clean them if necessary with a soft brush. Blocked air vents may lead to overheating and damage the machine.
4. Stop the engine immediately if you are disturbed while working by other people entering the working area. Always let the machine come to a complete stop before leaving the machine unattended.
5. Do not overwork yourself. Take regular breaks to ensure you can concentrate on the work and have full control over the machine.

Starting / Stopping



WARNING! BEFORE STARTING, PUT THE MACHINE ON A FLAT SURFACE FREE OF HIGH GRASS! CLEAN THE UNDERSIDE OF THE DECK!

KEEP YOURSELF READY! THE MACHINE WILL START MOVING FORWARD ONCE YOU HOLD THE SELF-PROPELLING LEVER (3) TOWARDS THE GRIP HANDLE (1)!

START THE ENGINE CAREFULLY ACCORDING TO INSTRUCTIONS.
KEEP YOUR FEET WELL AWAY FROM THE CUTTING BLADE (29)!

DO NOT TILT THE MACHINE WHEN STARTING THE ENGINE.

Starting

1. Press the primer (14) 3 times if the engine is cold (Fig. 17, step 1). You can go directly to the next step if the engine is warm.
2. Stand behind the grip handle (1).
3. Pull back the brake lever (2) and hold it against the grip handle (1) (Fig. 17, step 2).
4. Rest the recoil starter handle (27) onto the hook (26) located on the right-hand side of the upper handle bar (4).
5. Pull the recoil starter handle (27) lightly until you feel resistance then pull it rapidly. Do it repeatedly until the engine starts (Fig. 17, step 3).
6. When you are ready to mow, push the self-propelling lever (3) forward and hold it against the grip handle (1) (Fig. 17, step 4). The machine starts moving forward and begins mowing.

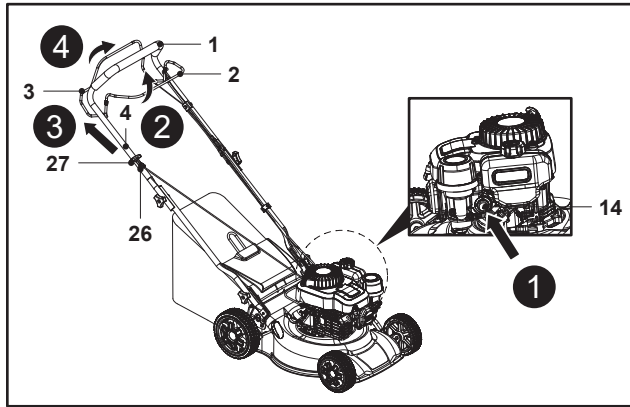

Fig. 17



WARNING! THE STARTING POSITION SHOULD BE AS DESCRIBED IN THE INSTRUCTION MANUAL. FIG. 18A ILLUSTRATES THE DEFINED STARTING POSITION. THE OPERATOR SHOULD START THE ENGINE BEHIND THE GRIP HANDLE (1). DO NOT START THE ENGINE WHILE STANDING ON THE SIDE OF THE MACHINE AS SHOWN ON FIG. 18B.

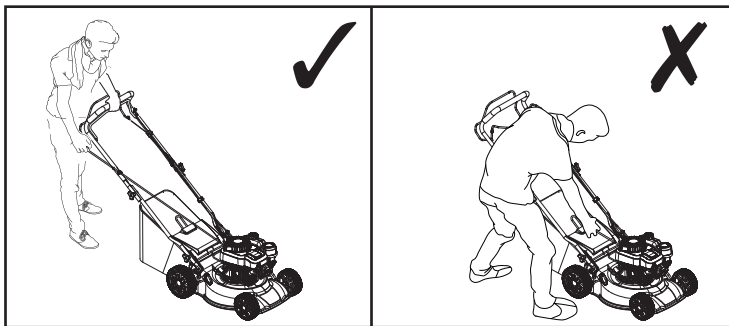

Fig. 18



NOTE: If the engine does not start, the engine may be flooded. Flooding is caused by too much fuel injected into the combustion chamber and can prevent a machine from starting. Follow below procedure:

1. Remove the spark plug (17a) and dry it.
2. Pull the recoil starter handle (27) for several times to drain the fuel from the combustion chamber.
3. Wait until fuel vapours evaporate and refit the spark plug. Clean up any spilled fuel and move the machine at least 3 metres (10') away before starting the engine to avoid any accidental fire. Wait for the engine to cool down then start the engine again.

Stopping

1. Release the self-propelling lever (3) to stop the self-propelled function (Fig. 19, step 1).
2. Release the brake lever (2) to stop the engine and cutting blade (29) (Fig. 19, step 2).

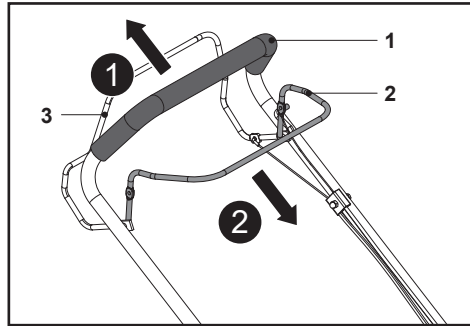

Fig. 19

Mowing

1. Make sure that the lawn is clear of stones, sticks, wire or other objects that could damage the machine or its engine.
2. Do not cut wet grass because it tends to stick to the underbody of the machine, preventing the proper discharge of grass clippings, and it could also cause you to slip and fall.
3. Never cut off more than one-third of the total length of the grass for a healthy lawn. In the autumn, lawns should only be cut as long as there is growth.
4. Slowly push the machine forward. You may want to use the self-propelled function for assistance.
5. Mow in slight overlapping rows. The most effective pattern for mowing lawns is straight lines along one of the sides. This will keep the rows even and ensures that all the lawn is cut without missing any spots (Fig. 20).
6. Circle around flower beds. When reaching a flower bed in the middle of the lawn, cut a row or two around the circumference of the bed.
7. Pay special attention when changing direction.
8. Empty the grass catcher (25) regularly.

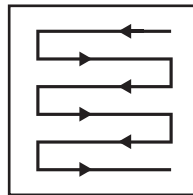

Fig. 20



WARNING! IF THE MACHINE STRIKES A FOREIGN OBJECT STOP IMMEDIATELY! LET THE MACHINE COOL DOWN AND THOROUGHLY INSPECT THE MACHINE FOR DAMAGE! HAVE ANY DAMAGE REPAIRED BEFORE RESTARTING!



EXTENSIVE VIBRATION OF THE MACHINE DURING OPERATION IS AN INDICATION OF DAMAGE! THE MACHINE SHOULD BE PROMPTLY INSPECTED AND REPAIRED!

9. Prepare the machine according to required application.

Function	Grass catcher	Mulching insert
Grass collection	attached	removed
Mulching	removed	inserted

Grass collection

1. Remove the mulching insert (30) and attach the grass catcher (25).
2. Empty the grass catcher (25) regularly.

Mulching



NOTE: Mulching means cutting and returning the grass clippings to the lawn in one step: the grass clippings are cut very fine and then distributed evenly back onto the lawn. Under normal conditions, the mulched grass will biodegrade quickly to provide nutrients to the lawn.

1. Insert the mulching insert (30) into the rear discharge chute (28), make sure the grass catcher (25) is not fitted to the machine.
2. Avoid mowing when the grass is wet from rain or dew. Wet grass may form clumps which interfere with the mulching action and reduce runtime. The best time to mow grass is late afternoon when the grass is dry and the newly cut area will not be exposed to direct sunlight.
3. Set the cutting height to about one third of the grass blade length, ideally no more than 35 mm at one time for best mulching performance. If the lawn is overgrown, it may be necessary to increase the cutting height to reduce the pushing effort and prevent the engine overloading. For extremely heavy mulching, it is advisable to first cut at a high cutting height, and then again to a lower cutting height. Otherwise, make narrower cuts and mow slowly.
4. Keep the housing free of built-up grass for best performance. From time to time stop the engine and wait for the blade to come to a complete stop. Then turn the machine on its side. Using an object such as a wooden stick, remove any accumulation of grass in the blade area. Be careful of the sharp edges of the blade. Clean often after cutting new grass and after every use.
5. Certain types of grass or grass conditions may require an area to be mulched a second time to fully disperse the grass across the lawn. When cutting a second time, it is advisable to cut perpendicular (across) the first cutting pattern. Do not change the cutting pattern in any way that would cause you to mow downhill.
6. Change your cutting pattern from week to week. This will help prevent matting and graining of the lawn.



NOTE: Fuel may leak from the fuel tank cap (12) and/or carburetor (13). Always ensure the fuel tank remains at a top position.

After use

1. The fuel must be drained out into a container after each use. Place the mower on stable ground and use the supplied syphon (32) to drain out all the petrol from fuel tank (Fig. 21).

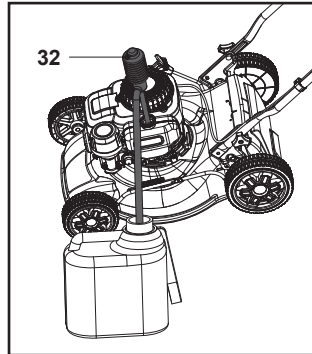

Fig. 21

2. After draining the fuel tank, screw the fuel tank cap (12) back and tighten it, start the engine, continue to run the engine until it stops from the lack of fuel in the carburetor fuel bowl. Running time is about 5 minutes.



WARNING! DO NOT ALLOW PETROL TO REMAIN IN YOUR ENGINE FOR LONG TERM STORAGE. DO NOT RUN THE ENGINE TOO LONG, OR IT WILL DAMAGE THE ENGINE!

3. Stop the engine, disconnect the spark plug connector (17) and let it cool down.



WARNING! THE SPARK PLUG (17A) WILL STAY HOT FOR A LONGER PERIOD OF TIME AFTER OPERATION!

4. Check, clean and store the machine as described below.

EN Care & maintenance

The golden rules for care



WARNING! PROPER MAINTENANCE IS ESSENTIAL FOR SAFE AND TROUBLE FREE OPERATION. IMPROPER MAINTENANCE, OR FAILURE TO ADDRESS A PROBLEM INSTANTLY CAN CAUSE A MALFUNCTION WHICH CAN RESULT IN SERIOUS INJURY OR EVEN DEATH.



WARNING! ALWAYS STOP THE ENGINE, DISCONNECT THE SPARK PLUG CONNECTOR (17) AND LET THE MACHINE COOL DOWN BEFORE PERFORMING INSPECTION, MAINTENANCE AND CLEANING WORK!



DO NOT TOUCH A ROTATING CUTTING BLADE (29).

1. Keep the machine clean. Remove debris from it after each use and before storage.
2. Regular and proper cleaning will help ensure safe use and prolong the life of the machine.
3. Inspect the machine before each use for worn and damaged parts. Do not operate it if you find broken and worn parts.
4. Replace worn parts as necessary or contact an authorised service centre for repair before using the machine again.



WARNING! ONLY PERFORM REPAIRS AND MAINTENANCE WORK ACCORDING TO THESE INSTRUCTIONS! ALL FURTHER WORKS MUST BE PERFORMED BY A QUALIFIED SPECIALIST!

General cleaning

1. Clean the machine with a slightly damp cloth and pH-neutral soap. Use a brush for areas that are hard to reach.
2. In particular clean the air vents (11) after every use with a cloth and brush.
3. Remove stubborn dirt with high pressure air (max. 3 bar).



NOTE: Do not use chemical, alkaline, abrasive or other aggressive detergents or disinfectants to clean this machine as they might be harmful to its surfaces.

Maintenance

Before and after each use, check the machine and accessories (or attachments) for wear and damage. If required, exchange them for new ones as described in this instruction manual. Observe the technical requirements.



WARNING! IT REQUIRES TO TIP THE MACHINE WHEN PERFORMING MAINTENANCE, THEREFORE THE FUEL TANK MUST BE EMPTY OTHERWISE THE FUEL CAN LEAK OUT AND RESULT IN A FIRE OR EXPLOSION.



NOTE: Always empty the fuel tank and keep the air filter (15a) / the spark plug (17a) upside. Otherwise the fuel or engine oil will contaminate them and cause difficulties to start the engine.

Maintenance table

Part	To do	Before/ after each use	First month or 5 hours	Every 3 months or 25 hours	Every 6 months or 50 hours	Every year or 100 hours	Every 2 years or 250 hours
Engine oil	check	x					
	replace				x		
Air filter	check	x					
	clean			x			
	replace						x

Part	To do	Before/ after each use	First month or 5 hours	Every 3 months or 25 hours	Every 6 months or 50 hours	Every year or 100 hours	Every 2 years or 250 hours
Spark plug	check/ adjust			x			
	clean			x			
	replace						x
Spark plug cap	clean					x	
Fuel tank and filter	clean			x			
Fuel tube	clean	Every 2 years (replace if necessary)					
Valve clearance	check/ adjust					x	
Muffler	check					x	
	clean					x	
	replace					x	
Combustion chamber	clean	Every 200 hours					
Flywheel brake pad	check				x		

Underbody and cutting blade



WARNING! WEAR PROTECTIVE GLOVES WHEN WORKING ON THE CUTTING BLADE (29) AND CLOSE TO IT! USE PROPER TOOLS TO REMOVE DEBRIS, E. G. A WOODEN STICK! NEVER USE YOUR BARE HANDS!



ALWAYS USE ORIGINAL SPARE PARTS FOR REPLACEMENT. THE CUTTING BLADE (29) MUST BE REPLACED BY AN IDENTIFICATION NO. REF. 1255261000. DO NOT ATTACH ANY OTHER TYPE OF CUTTING BLADE!

THE REPLACEMENT OF THE CUTTING BLADE (29) SHOULD BE DONE BY AN EXPERIENCED USER! REWORK OR SHARPENING BLADES IS NOT RECOMMENDED UNLESS IT IS DONE BY A REPAIR SERVICE OR A SIMILARLY QUALIFIED SPECIALIST!



NOTE: We strongly recommend jacking the machine when performing inspection and work on the cutting blade (29). Avoid tilting the machine in order to prevent fuel and oil leakages.

1. Keep the underbody and cutting blade (29) clean and free of debris. Remove clippings from the rear discharge chute (28).
2. Check all fasteners, such as nuts and bolts, periodically for tightness before operation. After prolonged use, especially in sandy soil conditions, the cutting blade (29) will become worn and lose some of the original shape. The cutting efficiency will be reduced and the cutting blade (29) should be replaced.
3. Keep the cutting blade (29) sharp to ensure a good cutting performance. Replace a worn or damaged cutting blade (29) with a new one of the same type or have it sharpened by a qualified specialist.
4. If jacking the machine is not possible, tilt it to the right side so that the fuel tank cap (12) side is up. This helps to prevent fuel leakage and harder starting due to flooding of the carburetor (13).
5. Loosen the hex bolt (29e) anti-clockwise using a suitable wrench (size 17 mm) and remove it together with the washer (29d), the cutting blade (29), the blade holder (29c) and the inner bushing (29b) from the spindle (29a).
6. Replace the cutting blade (29) with a new one of the same type. Refit the blade holder (29c) together with inner bushing (29b) to the spindle (29a), make sure that the slot of blade holder (29c) pass through the pin to the end of spindle (29a). Check the status of the flange onto the blade holder (29c), then attach the cutting blade (29) properly, fix the assembly with the washer (29d) and hex bolt (29e). Tighten the hex bolt (29e) clockwise with 45 Nm min, 60 Nm max. to ensure safe operation of your machine (Fig. 22).

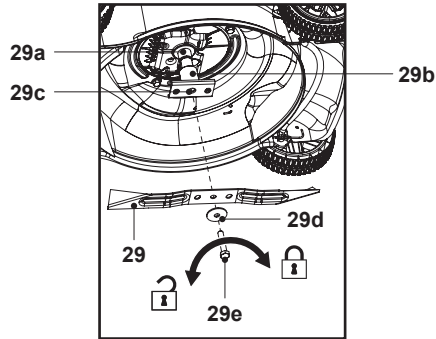

Fig. 22



DANGER! IF THE CUTTING BLADE (29) IS NOT TORQUED PROPERLY, IT COULD BECOME LOOSE AND BE THROWN FROM THE MACHINE AND SERIOUSLY HURT OR KILL THE OPERATOR OR BYSTANDERS.



NOTE: Replace this cutting blade (29) after 50 hours mowing or 2 years whichever is sooner regardless of condition. If the cutting blade (29) is cracked or damaged, you must immediately replace it with a new one.

7. Lubricate the cutting blade (29) after each use to prolong the life span of cutting blade and machine. Apply light machine oil along the edge of the cutting blade (29).

Grass catcher

1. Inspect the grass catcher (25) before each use. Do not use it if you find any damage.
2. Clean the grass catcher (25) after operation using water and mild soap.
3. Let the grass catcher (25) dry thoroughly before storing to avoid mildew.

Wires

Check the performance of the self-propelling wire (8) and the brake wire (9) before each use. Ask a qualified specialist to adjust it if necessary.



DANGER! DO NOT USE THE MACHINE WITH DEFECTIVE OR LOOSE WIRES (8, 9)!

Air filter



NOTE: A properly maintained air filter (15a) helps to prevent dirt from entering the engine. Entering dirt can cause blockages that can lead to premature engine wear or problems with starting or running the engine.

Wash the air filter (15a) every 25 hours (in dusty conditions or when airborne debris is present, clean more often).

1. Inspect the air filter (15a) regularly. Replace it with a new one if necessary.
2. Hold and rotate the air filter cover (15) anti-clockwise to disengage it, then remove it afterwards (Fig. 23, steps 1, 2).
3. Remove the air filter (15a) from the air filter base and tap it on a solid surface or blow it with air jet gun to remove dust (Fig. 23, step 3).
4. Apply a small amount of foam air filter oil on the air filter (15a) to increase its performance. Wipe out surplus oil and place the air filter (15a) back onto the air filter base.
5. Align the three locking latches (15b) with the slots on the air filter base and refit the air filter cover (15), then rotate it clockwise to secure (Fig. 23, step 4).

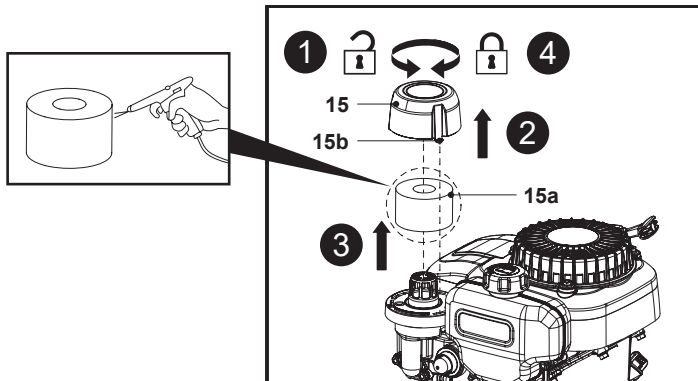

Fig. 23

Spark plug



NOTE: For good performance, the spark plug (17a) must be properly gapped and free of deposits.

Inspect the spark plug (17a) every 50 hours or before long-term storage over 180 days. Clean or replace with a new one if necessary (type: F6RTC).

1. Disconnect the spark plug connector (17) (Fig. 24).
2. Loosen the spark plug (17a) anti-clockwise using the spark plug wrench (33) and remove it carefully (Fig. 25).

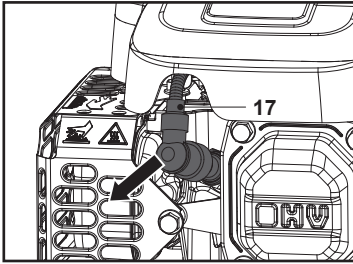

Fig. 24

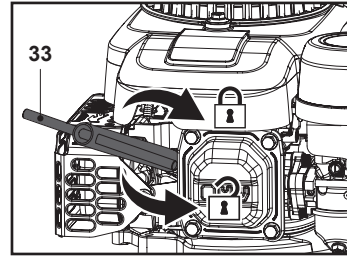

Fig. 25

3. Check the spark plug (17a) for damage and wear. The colour of the electrode should be light-brown.
4. Remove the deposits from the electrode with a soft wired brush. Avoid heavy cleaning of the electrode.
5. Dry the spark plug (17a) with a soft cloth, if it is wet from fuel.
6. Check the spark plug gap. It should be 0.7-0.8 mm (Fig. 26).
7. Replace with a new spark plug if either the electrode or the insulation is damaged.
8. When replacing the spark plug (17a), first screw it in hand tight and then lightly tighten it with the spark plug wrench (33).
9. Refit the spark plug connector (17), ensure the rubber pad around the spark plug connector is in correct position.

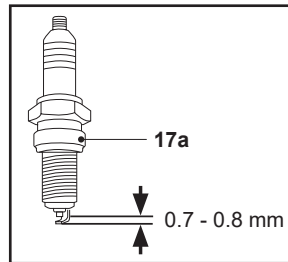

Fig. 26



WARNING! DO NOT OVER TIGHTEN THE SPARK PLUG (17A) TO AVOID ANY DAMAGE! FUEL



NOTE: Petrol deteriorates over time. Engine starting may be difficult if you use petrol kept for more than 30 days.

1. Empty the fuel tank when storing the machine over 30 days to prevent the fuel deteriorating.
2. Place a suitable container under the fuel drain screw (13a) to collect the fuel.
3. Unscrew the fuel drain screw (13a) and let the fuel run into the container (Fig. 27).
4. Screw the fuel drain screw (13a) back in and tighten it.
5. Wipe spilt fuel up.
6. Before re-use, refill the fuel tank as described in the "Fuel and engine oil - Fuel" section.

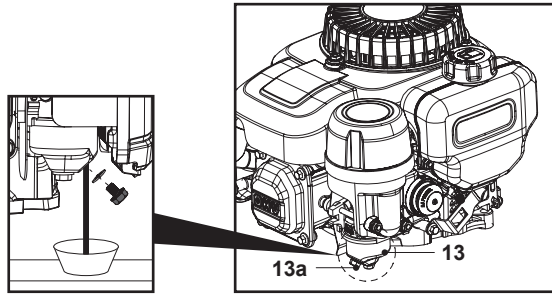

Fig. 27

Checking engine oil

i **NOTE:** Check the oil level and quality before each use. The oil must be replaced after every 6 months or after 50 hours of operation.

1. Unscrew and remove the oil tank cap (21).
2. Gradually add good-quality engine oil (SAE 10W-30). Allow the oil to settle.
3. Check the oil level frequently while filling. Wipe off oil dipstick and insert it into the tank opening without tightening the oil tank cap (21), and then remove the dipstick again.
4. The oil level must be between the oil level markings (Lower limit: 200 ml, Upper limit: 400 ml). Add more oil if necessary. Do not overfill.
5. After filling oil, wait 1 minute and then recheck the oil level.
6. Wipe the spilt oil with a soft cloth and reattach the oil tank cap (21).

Draining engine oil

i **NOTE:** Drain the oil every 50 hours of operation of every 6 months.



WARNING! BEFORE TILTING THE MACHINE FOR MAINTENANCE, THE FUEL TANK MUST BE EMPTY, OTHERWISE THE FUEL CAN LEAK OUT AND RESULT IN A FIRE OR EXPLOSION!

1. The oil should be clear and thick. If the oil is sticky or contains dirt particles, draining the oil is necessary.
2. Unscrew and remove the oil tank cap (21).
3. Place a suitable container next to the machine to collect the drained oil. Ensure the container has an efficient volume.
4. Tilt the machine to the side to drain the oil into the oil container.
5. Wipe spilled oil up.
6. Refill the oil tank as described in the "Fuel and engine oil - Engine Oil" section.

Carburettor

The carburetor (13) is preset by the manufacturer. Should it be necessary to make any changes, contact an authorised service centre or a similarly qualified specialist. Do not attempt to make any adjustments by yourself.

Muffler

Should it be necessary to modify or replace the muffler (19), contact an authorised service centre or a similarly qualified specialist. Do not attempt to make any adjustments by yourself.

Valve play

Have a qualified specialist check and adjust the valve play. Details for the specialist: IN = 0.10 ± 0.02 mm, EX = 0.10 ± 0.02 mm.

Spare parts / Replacement parts

The following parts of this machine may be replaced by the consumer. Spare parts are available at an authorized dealer or through our customer service.

Description	EAN
Spark plug (17a)	F6RTC
Cutting blade (29)	1255261000

Repair

This machine does not contain any parts that can be repaired by the consumer. Contact an authorised service centre or a similarly qualified person to have it checked and repaired.



NOTE: Adjustment of the self-propelling wire (8) may be necessary as it may stretch over time.

If the rear wheels (23) do not rotate when operating the self-propelling lever (3), it may be necessary to adjust the tightness of the self-propelling wire (8) (Fig. 28).

1. Ensure that the upper locking sleeve (8a) is held steady by the spanner (size: 10 mm), then turn the lower locking nut (8b) anticlockwise to loosen it by the other spanner (size: 10 mm).
2. Continue to turn the upper locking sleeve (8a) anticlockwise (upward) by hand and leave 3-5 threads.
3. Ensure that the upper locking sleeve (8a) is held steady by the spanner (size 10 mm), then use the other spanner (size: 10 mm) to turn the lower locking nut (8b) in clockwise to tighten it.

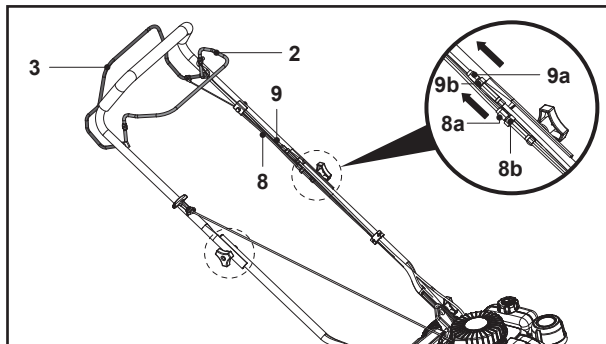

Fig. 28

If the brake wire (9) becomes loose after prolonged use and the brake lever (2) malfunctions, perform the above same operation on the upper locking sleeve (9a) and the lower locking nut (9b) to stretch the brake wire (9).

Storage



NOTE: Good storage conditions are important for keeping your machine trouble free.

1. Stop the engine and disconnect the spark plug connector (17) before storage.
2. Clean the machine as described in the “Cleaning” section.
3. Store the machine and its accessories in a dark, dry, frost-free, well-ventilated place.
4. Always store the machine in a place that is inaccessible to children. The ideal storage temperature is between 10 °C and 30 °C.
5. We recommend using the original package for storage or covering the machine with a suitable cloth or enclosure to protect it against dust.
6. Empty the fuel tank if you are not going to use the machine for an extended period of time (more than 30 days) and before storing it for the winter.

Transportation

1. Stop the engine and disconnect the spark plug connector (17) before transporting it anywhere.
2. Adjust the cutting height to the highest position as described in the “Cutting height adjustment” section.
3. Attach transportation guards, if applicable.
4. Always transport the machine by its grip handle (1) and the front transport handle (18).
5. If a suitable loading ramp is not available, ask another person for assistance when loading the machine on a vehicle.
6. Protect the machine from any heavy impact or strong vibrations which may occur during transportation in vehicles.
7. Secure the machine to prevent it from slipping or falling over, damage and injury.

Troubleshooting

Suspected malfunctions are often due to causes that the users can fix themselves. Therefore check the machine using this section. In most cases the problem can be solved quickly.



WARNING! ONLY PERFORM THE STEPS DESCRIBED WITHIN THESE INSTRUCTIONS! ALL FURTHER INSPECTION, MAINTENANCE AND REPAIR WORK MUST BE PERFORMED BY AN AUTHORISED SERVICE CENTRE OR A SIMILARLY QUALIFIED SPECIALIST IF YOU CANNOT SOLVE THE PROBLEM YOURSELF!

Problem	Possible cause	Solution
1. Engine does not start	1.1. Not enough fuel in fuel tank	1.1. Add fuel
	1.2. Spark plug is wet	1.2. Dry spark plug
	1.3. Spark plug is damaged	1.3. Replace spark plug
	1.4. Spark plug connector is loose	1.4. Attach properly
	1.5. Air filter is dirty	1.5. Clean air filter
	1.6. Spark plug is loose	1.6. Tighten spark plug 15-25 Nm
	1.7. Spark plug gap is incorrect	1.7. Set gap between electrodes at 0.7 to 0.8 mm

Problem	Possible cause	Solution
1. Engine does not start	1.8. Primer not pressed before for cold engine start	1.8. Press the primer for 3 times and restart
	1.9. Carburetor is flooded with fuel	1.9. Remove the spark plug and pull recoil starter handle continuously until carburetor clears itself
	1.10. Faulty ignition module	1.10. Contact an authorised service agent
2. Engine stops	2.1. Not enough fuel in fuel tank	2.1. Add fuel
	2.2. Cutting device is blocked	2.2. Remove blockage
3. Engine difficult to start or loses power	3.1. Dirt, water or stale fuel in the tank	3.1. Drain fuel and clean tank. Fill tank with clean, fresh fuel
	3.2. Vent hole in fuel tank cap is clogged	3.2. Clean or replace fuel tank cap
	3.3. Air filter is dirty	3.3. Clean air filter
	3.4. Primer not pressed before for cold engine start	3.4. Press the primer for 3 times and restart
4. Engine operates erratically	4.1. Spark plug is defective	4.1. Install new, correctly gapped plug
	4.2. Spark plug gap is incorrect	4.2. Set gap between electrodes at 0.7 to 0.8 mm
	4.3. Air filter is dirty	4.3. Clean air filter
5. Engine idles poorly	5.1. Air filter is dirty	5.1. Clean air filter
	5.2. Air vents are clogged	5.2. Remove debris from vents
	5.3. Cylinder fins are blocked	5.3. Remove debris from cylinder fins
6. Engine skips at high speed	6.1. Gap between electrodes of spark plug is too close	6.1. Set gap between electrodes at 0.7 to 0.8 mm
7. Engine overheats	7.1. Air vents are clogged	7.1. Remove debris from vents
	7.2. Incorrect spark plug	7.2. Install correct spark plug and cylinder fins on engine
8. Unsatisfactory result	8.1. Cutting device is dull	8.1. Replace with a new one
	8.2. Cutting material exceeds capacity	8.2. Only cut materials acc. to the capacity of the machine
	8.3. Cutting height is incorrect	8.3. Adjust cutting height
9. Excessive vibration / noise or exhaust	9.1. Cutting device is dull / damaged	9.1. Replace with a new one
	9.2. Bolts / nuts are loose	9.2. Tighten bolts / nuts
	9.3. Petrol / oil type is incorrect	9.3. Drain the petrol / oil and refill with the correct petrol / oil

Recycling and disposal

Old machines are potentially recyclable and do not, therefore, belong in your household rubbish. You are requested to assist us and our contribution to saving resources and protecting the environment by handing in this machine at an equipped collection centre (if there is one available).

Petrol, oil, used oil, a mixture of oil and petrol and objects soiled with oil e. g. cleaning cloths do not belong in the household rubbish. Dispose of oil-contaminated items in accordance with the local guidelines and hand them in at recycling centres.

The machine comes in a package that protects it against damage during shipping. Keep the package until you are sure that all parts have been delivered and the machine is function properly. Recycle the package afterwards.

Guarantee

We take special care to select high quality materials and use manufacturing techniques that allow us to create products incorporating design and durability. This product has a manufacturer's guarantee of 2 years against manufacturing defects, from the date of purchase (if bought in store) or date of delivery (if bought online), at no additional cost for normal (non-professional or commercial) household use.

To make a claim under this guarantee, you must present your proof of purchase (such as a sales receipt, purchase invoice or other evidence admissible under applicable law), please keep your proof of purchase in a safe place. For this guarantee to apply, the product you purchased must be new, it will not apply to second hand or display products. Unless stated otherwise by applicable law, any replacement product issued under this guarantee will only be guaranteed until expiry of the original period guarantee period.

This guarantee covers product failures and malfunctions provided the product was used for the purpose for which it is intended and subject to installation, cleaning, care and maintenance in accordance with the information contained in these terms and conditions, in the user manual and standard practice, provided that standard practice does not conflict with the user manual.

This guarantee does not cover defects and damage caused by normal wear and tear or damage that could be the result of improper use, faulty installation or assembly, neglect, accident, misuse, or modification of the product. Unless stated otherwise by applicable law, this guarantee will not cover, in any case, ancillary costs (shipping, movement, costs of uninstalling and reinstalling, labour etc), or direct and indirect damage.

This guarantee does not cover defects and damage caused by or resulting from:

- Normal wear and tear
- Overload, misuse or neglect
- Repairs attempted by anyone other than an authorised agent
- Cosmetic damage
- Damage caused by foreign objects, substances or accidents
- Accidental damage or modification
- Failure to follow manufacturer's guidelines
- Loss of use of the goods

If the product is defective, we will, within a reasonable time, repair, replace, refund, service or provide spare parts.

Rights under this guarantee are enforceable in the country in which you purchased this product. Guarantee related queries should be addressed to the store you purchased this product from.

The guarantee is in addition to and does not affect your statutory rights.

IMPORTANT - RETAIN THIS INFORMATION FOR FUTURE REFERENCE: READ CAREFULLY

Customer care and technical helpline

A better way to repair your tools

Kingfisher takes special care in creating high-quality garden power tools that are designed to last. But if a fault develops with your garden power tool and you need to claim under the guarantee, the Customer Care and Technical Helpline can support with technical assistance or if required, arrange a free courier collection from your home, assess your garden power tool for fault, repair it, and return it.

Deciding to repair your product rather than buying a replacement and adding to the mountain of waste is a more sustainable choice and you will be doing your bit for the environment.

How does it work?



 *** NOTE:** Before collection, all fuel must be removed from petrol powered machines.

Get in touch

If you need help or more information, please contact the Customer Care and Technical Helpline:

UK 0330 678 3077

ROI 1 800 365 800

Opening hours are Monday – Friday, 8 am-5 pm

Availability of spare parts

Contact the customer service helpline for assistance or visit www.kingfishersparses.com

For assistance contact the customer services helpline:

UK 0330 678 3077 uk@kingfisherservice.com

ROI 1 800 365 800 eire@kingfisherservice.com

Further information about this product can also be found at:

www.kingfisher.com/products





(EN) EU DECLARATION OF CONFORMITY
(FR) DÉCLARATION UE DE CONFORMITÉ
(PL) DEKLARACJA ZGODNOŚCI UE
(RO) DECLARAȚIA DE CONFORMITATE UE
(ES) DECLARACIÓN UE DE CONFORMIDAD
(PT) DECLARAÇÃO DE CONFORMIDADE UE

Product/Produit/Produkt/Produsul/Producto/Produto

- Petrol lawnmower / Tondeuse à gazon thermique / Kosiarka spalinowa / Mașină de tuns iarba cu benzină / Cortacésped de gasolina / Cortador de grama a gasoline
- NMU1299LWM, 132 cm³, 2.1 kW, 41 cm
- SN: 000001 to 999999

Name and address of the manufacturer or his authorised representative:

Nom et adresse du fabricant ou de son mandataire:

Nazwa i adres producenta lub jego upoważnionego przedstawiciela:

Denumirea și adresa producătorului sau a reprezentantului său autorizat:

Nombre y dirección del fabricante o de su representante autorizado:

Nome e endereço do fabricante ou do respetivo mandatário:

Kingfisher International Products B.V.,
Rapenburgerstraat 175E,
1011 VM Amsterdam,
The Netherlands

This declaration of conformity is issued under the sole responsibility of the manufacturer.

La présente déclaration de conformité est établie sous la seule responsabilité du fabricant.

Niniejsza deklaracja zgodności wydana zostaje na wyłączną odpowiedzialność producenta.

Prezenta declarație de conformitate este emisă pe răspunderea exclusivă a producătorului.

La presente declaración de conformidad se expide bajo la exclusiva responsabilidad del fabricante.

A presente declaração de conformidade é emitida sob a exclusiva responsabilidade do fabricante.

Object of the declaration/Objet de la declaration/Przedmiot deklaracji/Obiectul declarației/Objeto de la declaración/Objeto da declaração

Product/Produit/Produkt/Produsul/Producto/Produto

Model/Modèle/Model/Modelul/Modelo/ Modelo

EAN

Petrol lawnmower / Tondeuse à gazon thermique / Kosiarka spalinowa / Mașină de tuns iarba cu benzină / Cortacésped de gasolina / Cortador de grama a gasoline

NMU1299LWM

5063022748980

The object of the declaration described above is in conformity with the relevant Union harmonisation legislation:

L'objet de la déclaration décrit ci-dessus est conforme à la législation d'harmonisation de l'Union applicable:

Wymieniony powyżej przedmiot niniejszej deklaracji jest zgodny z odnośnymi wymaganiami unijnego prawodawstwa harmonizacyjnego:

Obiectul declarației descris mai sus este în conformitate cu legislația relevantă de armonizare a Uniunii:

El objeto de la declaración descrita anteriormente es conforme con la legislación de armonización pertinente de la Unión:

O objeto da declaração acima descrito está em conformidade com a legislação de harmonização da União aplicável:

2006/42/EC as amended Machinery Directive
 2014/30/EU as amended Directive Electromagnetic compatibility
 2000/14/EC as amended Outdoor Noise Directive
 2016/1628/EU Regulation Gaseous and Particulate Pollutant Emission Limits
 2011/65/EU as amended Directive on the restriction of the use of certain hazardous substances in electrical and electronic equipment
 Directive 2006/42/CE relative aux machines
 2014/30 / UE telle que modifiée Directive Compatibilit   electromagn  tique
 Directive 2000/14/CE relative aux   missions sonores ext  rieures
 R  glement (UE) 2016/1628 relatif aux exigences concernant les limites d'  mission pour les gaz polluants et les particules polluantes
 Directive 2011/65/UE relative    la limitation de l'utilisation de certaines substances dangereuses dans les   quipements   lectriques et   lectroniques
 2006/42/WE w zmienionej dyrektywie maszynowej
 2014/30 / UE ze zmianami Dyrektywa Kompatybilno   elektromagnetyczna
 2000/14/WE w zmienionej dyrektywie w sprawie ha  su na zewn  trz
 2016/1628/UE limity emisji zanieczyszcze   gazowych i cz  stek sta  ych
 2011/65/UE zgodnie z wprowadzonymi poprawkami Dyrektywa w sprawie ograniczenia stosowania niekt  rych niebezpiecznych substancji w sprz  cie elektrycznym i elektronicznym
 2006/42/CE, astfel a fost modificat   Directiva privind echipamentele
 2014/30/UE, astfel a fost modificat   Directiva privind compatibilitatea electromagnetice
 2000/14/CE, astfel a fost modificat   Directiva privind zgomotul   n aer liber
 2016/1628/UE Regulamentul privind emisiile de poluan  i gazo  i   i de particule poluante
 2011/65/UE cum a fost modificat   Directiva Restric  iile de utilizare a anumitor substan  e periculoase   n echipamentele electrice   i electronice
 Directiva sobre maquinaria modificada 2006/42/CE
 2014/30/UE modificada Directiva Compatibilidad electromagn  tica
 2000/14/CE modificada Directiva sobre ruido al aire libre
 2016/1628/Reglamento de la UE L  mites de emisiones de contaminantes gaseosos y part  culas
 2011/65/UE seg  n enmendado Directiva sobre restricciones a la utilizaci  n de determinadas sustancias peligrosas en aparatos el  ctricos y electr  nicos
 2006/42/CE como diretiva de m  quinas alteradas
 2014/30/UE como altera  o da compatibilidade eletromagn  tica
 2000/14/CE como diretiva de ru  do exterior alterada
 L  mites de emiss  o de poluentes gasosos e de poluentes de part  culas 2016/1628/REGULAMENTO da UE
 2011/65/UE conforme alterado Directiva Restri  o do uso de determinadas subst  ncias perigosas em equipamentos el  ctricos e electr  nicos

Measured Sound Power Level

Le niveau de puissance acoustique mesur  

Zmierzony poziom mocy akustycznej

Nivel de putere acustic   m  surat

Nivel de potencia sonora medido

Nivel de pot  ncia sonora medido

: 94,2 dB(A)

Guaranteed Sound Power Level

Le niveau de puissance acoustique garant

Gwarantowany poziom mocy akustycznej

Nivel de putere acustic   garantat

Nivel de potencia sonora garantizado

Nivel de pot  ncia sonora garantido

: 96 dB(A)

Engine Model

Mod  le de moteur

Model silnika

Modelul motorului

Modelo de motor

Modelo de motor

: NP130

T  V Rheinland LGA Products GmbH, TillystraBe 2,90431 N  rnberg, Germany (0197), performed EC-Type Examination according to Outdoor Noise Directive 2000/14/EC Annex VI. EC Type Approval No: JO 60177296 0001.

TÜV Rheinland LGA Products GmbH, TillystraBe 2,90431 Nürnberg, Germany (0197) a effectué l'examen CE de type conformément à l'annexe VI de la directive 2000/14/CE sur le bruit extérieur. Approbation de type CE Non : JO 60177296 0001.

TÜV Rheinland LGA Products GmbH, TillystraBe 2,90431 Nürnberg, Germany (0197) przeprowadził badanie typu WE zgodnie z dyrektywą w sprawie hałasu zewnętrznego 2000/14/WE załącznik VI. Homologacja typu WE nr: JO 60177296 0001.

TÜV Rheinland LGA Products GmbH, TillystraBe 2,90431 Nürnberg, Germany (0197) a efectuat examinarea CE de tip în conformitate cu Directiva privind zgomotul exterior 2000/14/CE anexa VI. Nr. omologare CE de tip: JO 60177296 0001.

TÜV Rheinland LGA Products GmbH, TillystraBe 2,90431 Nürnberg, Germany (0197) realizó el examen CE de tipo de acuerdo con la Directiva de ruido exterior 2000/14/CE Anexo VI. No de homologación de tipo CE: JO 60177296 0001.

TÜV Rheinland LGA Products GmbH, TillystraBe 2,90431 Nürnberg, Germany (0197) realizou o Exame CE do Tipo de acordo com o Anexo VI da Diretiva 2000/14/CE relativa ao ruído exterior. Aprovação do tipo CE Não: JO 60177296 0001

References to the relevant harmonised standards used or references to the other technical specifications in relation to which conformity is declared:

Références des normes harmonisées pertinentes appliquées, y compris la date de celles-ci, ou des autres spécifications techniques, y compris la date de celles-ci, par rapport auxquelles la conformité est déclarée:

Odwolania do odnośnych norm zharmonizowanych, które zastosowano, wraz z datą normy, lub do innych specyfikacji technicznych, wraz z datą specyfikacji, w odniesieniu do których deklarowana jest zgodność:

Trimiteri la standardele armonizate relevante folosite, inclusiv data standardului, sau trimiteri la celelalte specificații tehnice, inclusiv data specificațiilor, în legătură cu care se declară conformitatea:

Referencias a las normas armonizadas pertinentes utilizadas, incluidas las fechas de las normas, o referencias a las otras especificaciones técnicas, incluidas las fechas de las especificaciones, respecto a las cuales se declara la conformidad:

Referências às normas harmonizadas aplicáveis utilizadas, incluindo a data da norma, ou às outras especificações técnicas, incluindo a data da especificação, em relação às quais é declarada a conformidade:

EN ISO 5395-1:2013+A1:2018

EN ISO 5395-2:2013+A1:2016+A2:2017

EN ISO 14982:2009

EN ISO 3744:1995

ISO 11094:1991

Authorised signatory and technical file holder/signataire et responsable de la documentation technique autorisé/podmiot uprawniony do wystawienia i adres przechowującego dokumentacji technicznej/semnatar autorizat și deținător al dosarului tehnic/firmante autorizado y titular del expediente tecnico/signatário autorizado e detentor da ficha técnica

Kingfisher International Products B.V.,
Rapenburgerstraat 175E,
1011 VM Amsterdam,
The Netherlands



David Awe
Group Quality Director
Directeur Qualité Groupe
Dyrektor ds. Jakości Grupy
Director Calitate Grup
Director de Calidad del Grupo
Diretor de Qualidade do Grupo

: [25/08/2025]

Manufacturer:

UK Manufacturer:

Kingfisher International Products Limited,
1 Paddington Square, London, W2 1GG,
United Kingdom

EU Manufacturer:

Kingfisher International Products B.V.,
Rapenburgerstraat 175E,
1011 VM Amsterdam,
The Netherlands

EN www.diy.com

www.screwfix.com

www.screwfix.ie

**To view instruction manuals online,
visit www.kingfisher.com/products**